



6 things you need to know.

1. A LEED Performer

Thermaguard™ is the only 100% thermal/air barrier precast system, reducing transfer as much as 25%. Reduced concrete usage, factory applied R-42 closed-cell insulation and thermal windows seal the deal.

2. Lighten The Load

Industry leading lightweight panels reduce the load for foundations and decrease the number of frame connections that need to be made.

3. "Bonus" square footage

Outboard-of-floor-edge mounting creates more sellable square footage within the same footprint as traditional building methods.

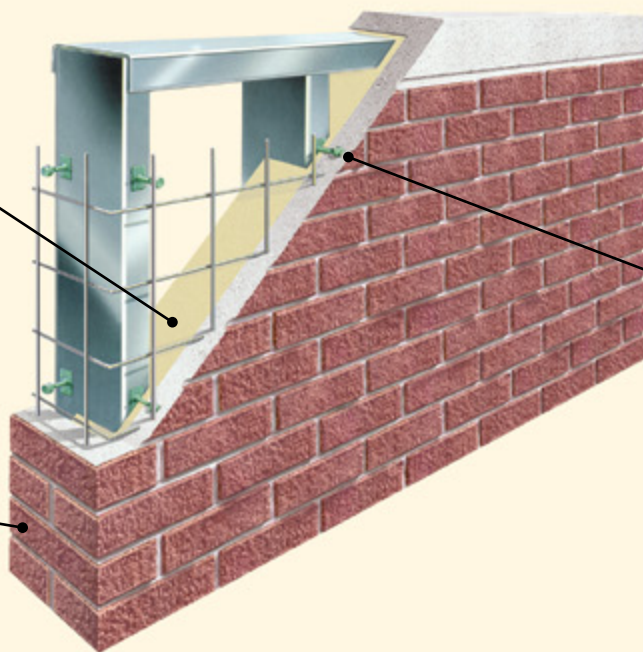

4. Cut Installation Costs

Lift-and-Release™ is the only panel installation landing system that increases rates by 50%. Windows come preinstalled and drywall can be mounted directly to the stud frame, both saving time and labor.

5. Less Stress

Patented DuraFlex 360°™ stud frame connectors isolate the precast skin from structural stresses.

6. Proven Technologies

Our "Class A" concrete finishes, welded-wire fabric, galvanized steel studs, stainless steel stud anchors and water infiltration systems have all been field tested and approved.

SLENDERWALL®

An Award-winning Architectural Precast and Steel-Stud Exterior Panel System

Call today to receive your free copy of our 308 page Architectural Portfolio and Technical Design Guide



1-800-547-4045
eco.slenderwall.com

Slenderwall® is a product of Easi-Set® Worldwide, a licensor of precast products and a wholly-owned subsidiary of Smith-Midland (DE).

